

LAND FOR SALE

# Veterans Drive Site

710 - 44th Ave North  
St. Cloud, MN



**RICE**  
REAL ESTATE  
SERVICES

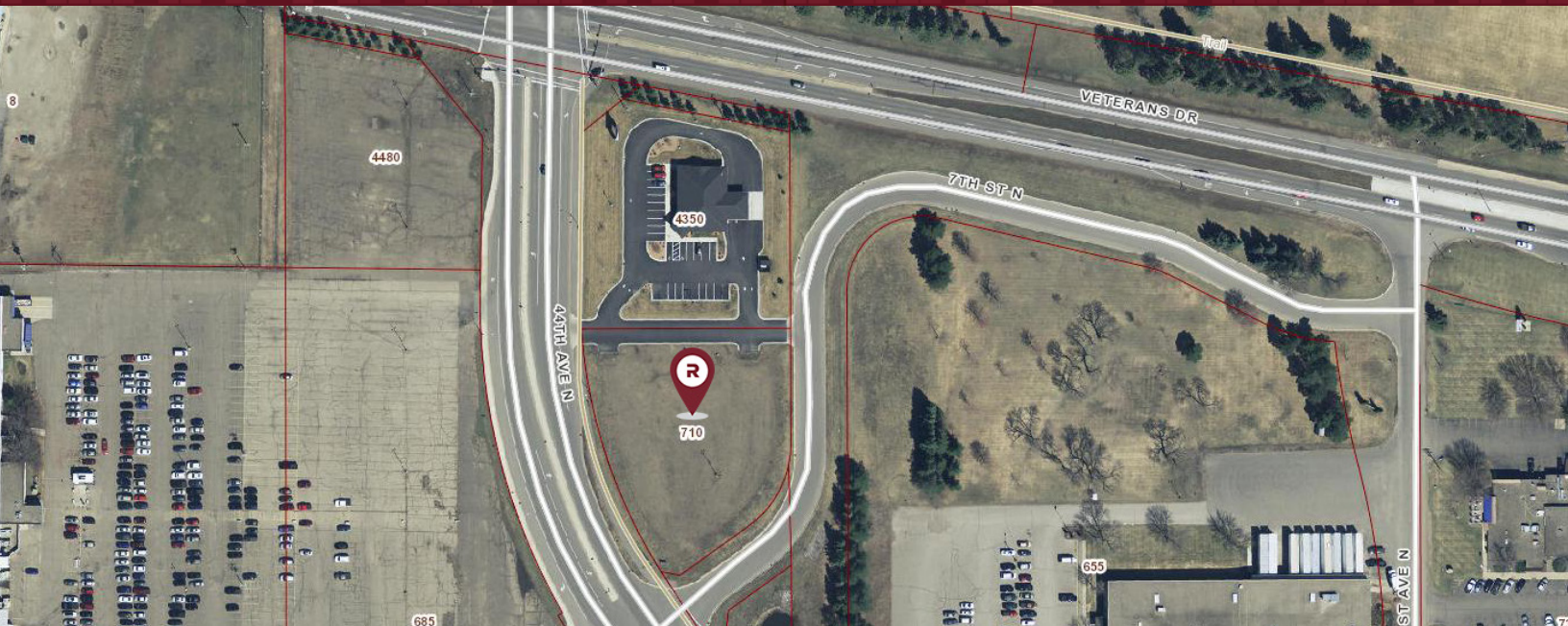

## 1.23 Acres or 53,578 SF

Pad site available for purchase or build to suit. Located off Veterans Drive near Sentry Bank in St. Cloud. 44th Avenue North, off Veterans Drive, is a major artery which connects consumers and commuters to retailers and commerce in the St. Cloud and Waite Park area.

Current zoning is 3-A Commercial/Industrial/Public Utility. Building to lot ratio is 25% which can accommodate a 13,000+/- sf building. This site is ideal for professional office, retail and specialty users.

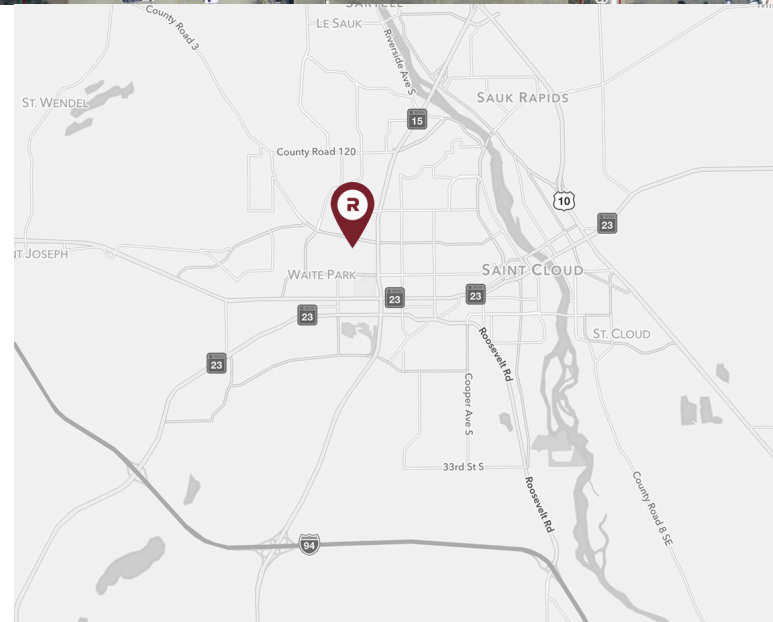

**SALE PRICE: \$425,000 or \$8.00/ PSF**

FOR ADDITIONAL  
INFORMATION,  
PLEASE CONTACT:

CASEY O'MALLEY  
PRIMARY BROKER | 320.260.6815  
casey.omalley@riceproperties.com



1019 Industrial Drive South,  
Sauk Rapids, MN 56379  
320.260.6815 | RICEPROPERTIES.COM

We obtained the information above from sources we believe to be reliable. However, we claim to make a guarantee, warranty or representation about such information. It is submitted subject to the possibility of errors, omissions, change of price, rental or other conditions, prior sale, lease or financing, or withdrawal without notice. You and your tax and legal advisors should conduct your own investigation of the property and transaction.

PROPERTY PHOTOS

# Veterans Drive Site

710 - 44th Ave North  
St. Cloud, MN



**RICE**  
REAL ESTATE  
SERVICES



FOR ADDITIONAL  
INFORMATION,  
PLEASE CONTACT:

CASEY O'MALLEY  
PRIMARY BROKER | 320.260.6815  
casey.omalley@riceproperties.com



1019 Industrial Drive South,  
Sauk Rapids, MN 56379  
320.260.6815 | RICEPROPERTIES.COM

We obtained the information above from sources we believe to be reliable. However, we claim to make a guarantee, warranty or representation about such information. It is submitted subject to the possibility of errors, omissions, change of price, rental or other conditions, prior sale, lease or financing, or withdrawal without notice. You and your tax and legal advisors should conduct your own investigation of the property and transaction.